

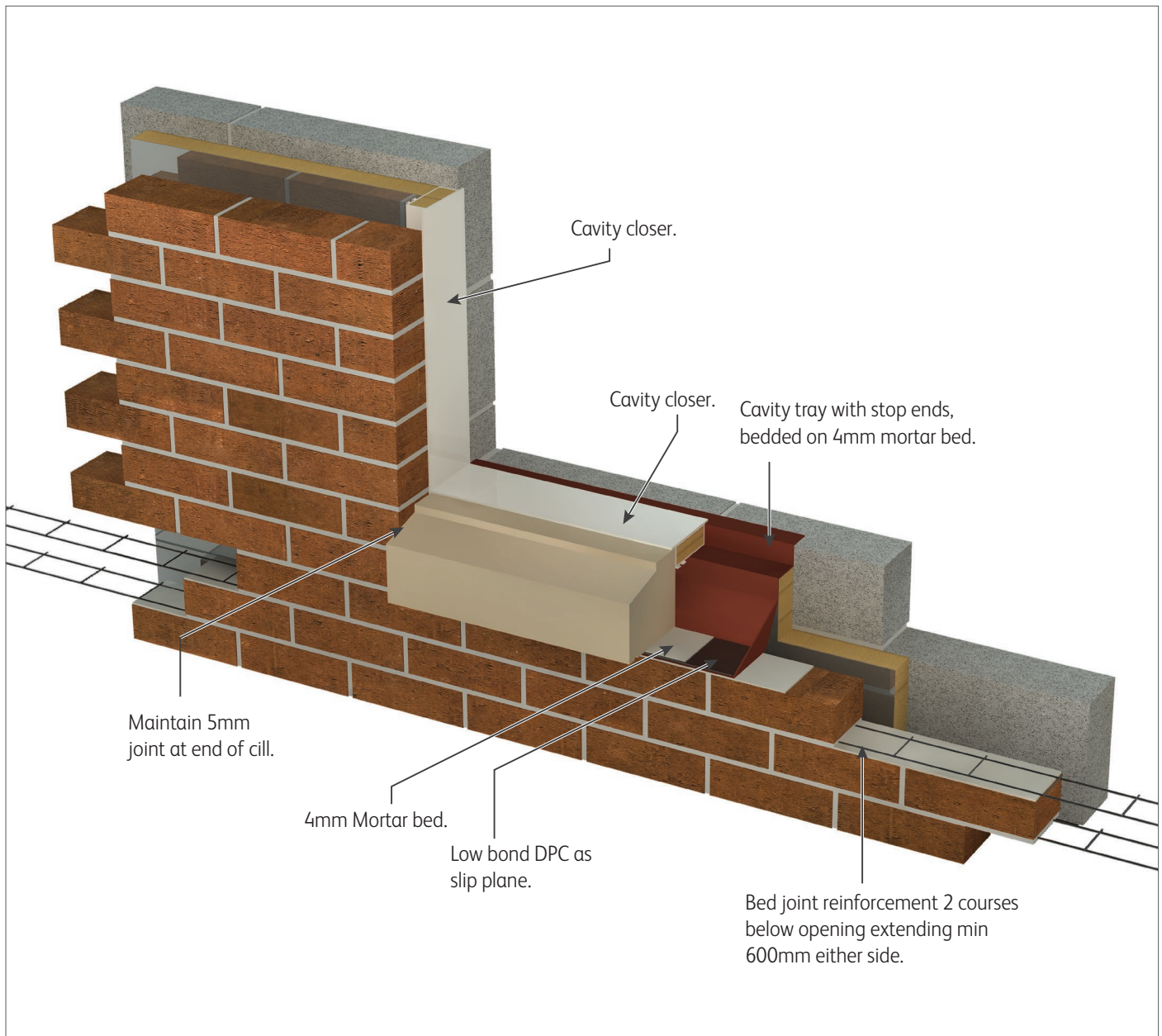

CAST STONE SLIP CILL DETAIL

Cast stone slip cills are designed to fit between window reveals. They are available as one piece units up to 1547mm (dependent on unit height).

It is crucial that movement of cast stone components is accommodated.

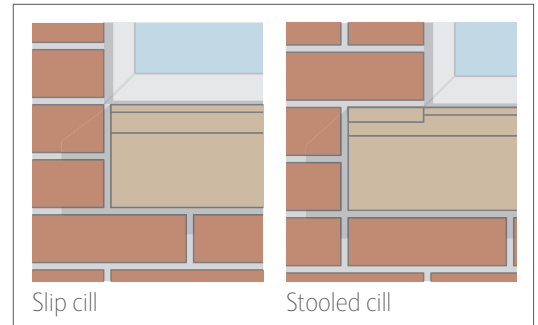



CAST STONE SLIP CILL DETAIL

To avoid stresses from differential movement the cill should be installed to following guidance. For one piece cills up to 1547mm and multiple piece cills;

1. At the window opening sit the cavity tray with stop ends, on a 4mm mortar bed.
2. Place a further length of DPC material on top of the outer leaf surface of the cavity tray to act as a slip plane.
3. Compressible or tube style weep vents should be positioned at each end of the cavity tray.
4. On top of the second DPC layer place a further 4mm mortar and carefully place the cill in position.
5. The front of the cill should project 50mm from the facing masonry or render below.
6. To maintain free movement at the cill ends, insert backing cord above the weep vent and apply flexible sealant the same colour as surrounding mortar or stone colour. Pointing mortar will restrict movement.

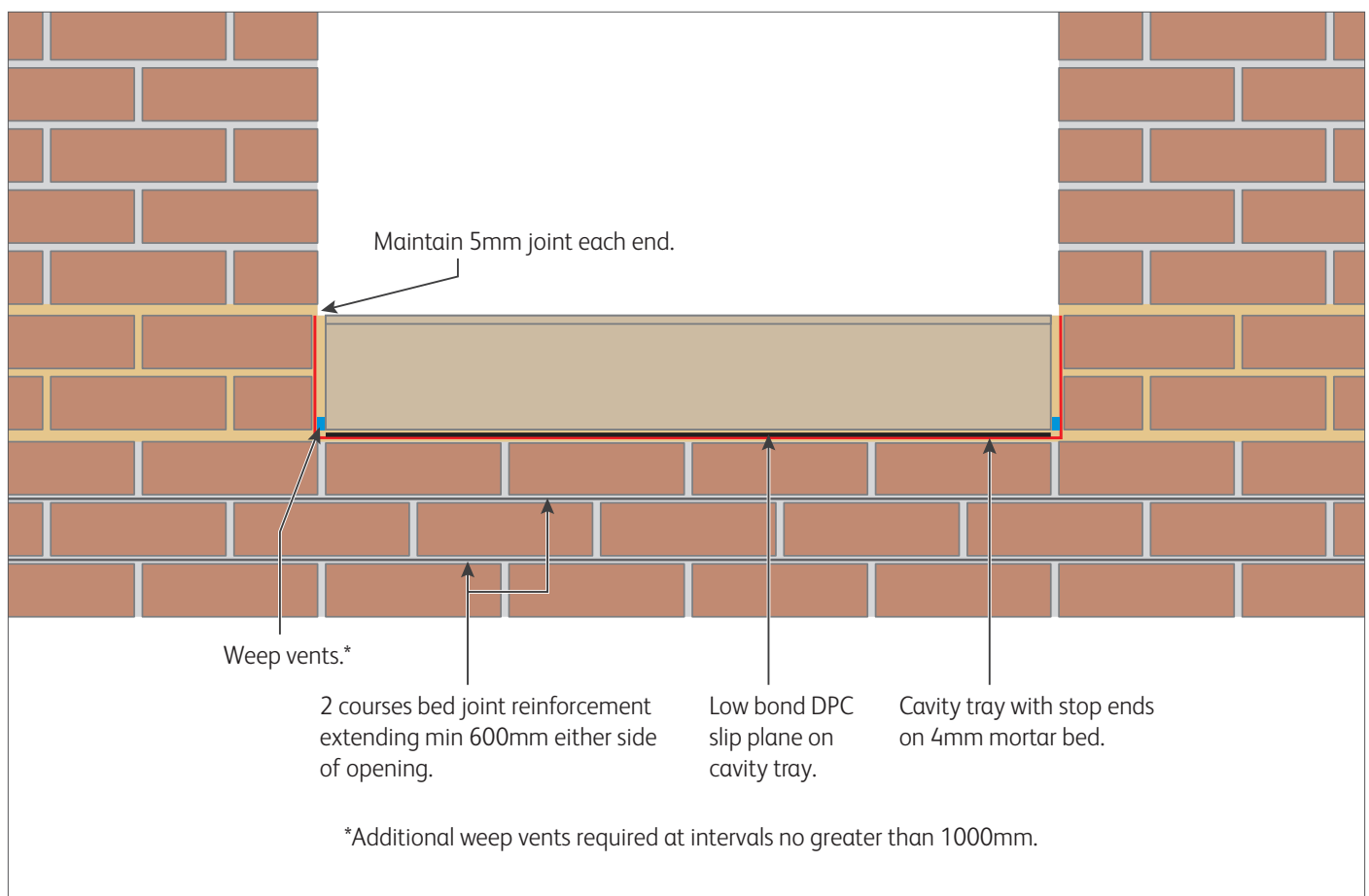



CAST STONE **SLIP CILL DETAIL**

Generally, when laying cast stone products mortar strength should not exceed designation (iii), 1:1:5 / 6 cement:lime:sand proportional mix. The use of lime is desirable to accommodate movement. Mortar no stronger than strength class M4 can be specified however movement may be restricted if lime is not a constituent element.

Cracking can occur if mortar of a higher strength than recommended is used or if movement of the cill is restricted by mortar pointing.

Refer to Technical Information Sheet 5 for recommended associated materials, Technical Information Sheet 3 for mortar specification, and the Forticrete Sitework Guide for further information.

Note: Whilst PD6697 does not include bed joint reinforcement above and below windows/doors in brickwork (but it does in blockwork), it is now considered good practice by the BDA (Brick Development Association) and brick manufacturers to include it in brickwork. It is for this reason that we include it in our Installation Guides’.

Although the instructions contained in this publication and any other information published by Forticrete Ltd are believed to be accurate at the date of publication, they are strictly for guidance only and Forticrete Ltd accepts no liability in relation to their use or for any losses, howsoever caused. You are responsible for taking all reasonable steps to ensure your use of the product conforms to all applicable health and safety requirements from time to time. If in doubt, please consult appropriately qualified persons. All products sold by Forticrete are sold subject to Forticrete Terms and Conditions of Sale, a copy of which is available on request.

